



Commonwealth Environmental Associates, Inc.

7411 Iron Bridge Rd. • Richmond, VA 23237 • 804.275.9320 • Fax: 804.275.9322

July 23, 2019

Food Lion, Inc.
P.O. Box 1330
Salisbury, North Carolina 28144

Attn: Mr. Alan Livengood

Re: Asbestos Survey Findings Report
Store 2250 – Closed Bi-Lo
1555 E. Union Street
Morganton, North Carolina
CEA Project No. 22419

Dear Mr. Livengood:

Commonwealth Environmental Associates, Inc. (CEA) is pleased to submit this Asbestos Survey for the above referenced site. These services have been performed in accordance with our standard terms and limitations.

Purpose of Study

To obtain representative samples of suspect asbestos containing materials (ACM) for laboratory analysis from Store 2250 in anticipation of a possible future remodel.

Scope of Services

Our scope of services for this project included the following:

- The identification and representative sampling of suspect asbestos building materials within the retail building by asbestos inspectors certified in North Carolina.
- Submission of samples to CEI Labs located in Cary, North Carolina for bulk asbestos analyses utilizing polarized light microscopy (PLM).
- Preparations of this findings report presenting identified asbestos containing materials, bulk asbestos analysis, pertinent QA/QC information and any conclusions and recommendations.

Asbestos Inspection

CEA asbestos inspectors performed a site visit on July 10, 2019 to identify and collect samples of suspected asbestos containing materials (ACM) within the retail building. CEA identified the sampling areas as homogenous and sampled accordingly. Materials identified and sampled in the study area included drop ceiling tile, dry wall / compound, vinyl floor tile, vinyl floor tile mastic, vinyl baseboard adhesive and ceramic tile grout / glue. The materials sampled on the exterior of the masonry structure included caulking and stucco. The building has a vinyl membrane roof which was not sampled or penetrated during this study. The materials collected during this study and the associated laboratory analysis is presented as Table 1 in Attachment A.

Materials noted at the site and not sampled during this study included plastics, natural wood products, silicon, foam, glass and concrete.

Laboratory Analysis

CEA submitted the thirty-five (35) samples collected within the study area of Store 2250 to CEI Labs located in Cary, North Carolina for PLM analysis. Including the laboratory separated samples, forty-five (45) samples were analyzed during this study. Of the forty-five (45) samples analyzed, none were reported to contain asbestos. The EPA defines asbestos containing materials as any material containing 1% or greater asbestos fiber content. OSHA defines asbestos containing material as any material containing any detectable percentage of asbestos. Certificates of Analysis are presented as Attachment B.

Conclusions and Recommendations

Based on CEA's inspection on July 10, 2019 of the area of Store 2250 slated for a possible future renovation and laboratory analysis of the suspected ACM samples collected at the site, asbestos was identified in none of the forty-five (45) samples collected from the materials identified as suspect ACM and analyzed during this study.

Commonwealth Environmental Associates, Inc. appreciates the opportunity to provide asbestos inspection services for this project. If you should have any questions, please do not hesitate to contact our office at (804) 275-22500.

Sincerely,

COMMONWEALTH ENVIRONMENTAL ASSOCIATES, INC.

A handwritten signature in black ink, appearing to read 'W. F. Mayes', with a stylized flourish at the end.

William F. Mayes
Asbestos Inspector

North Carolina License No. 11265

Attachments: A – Tables
 B - Certificates of Analyses

Asbestos Limitations for Inspection, Bulk Sampling and Analysis Reports

This report has been prepared for the exclusive use of Food Lion, Inc. and/or their agents. This report has been prepared in accordance with generally accepted environmental practices. No other warranty, expressed or implied, is made. Our conclusions and recommendations are based, in part, upon information provided to us by others and our site observations. We have not verified the completeness or accuracy of the information provided by others.

Our observations and recommendations are based upon conditions readily visible during the site at the time of our site visit, and upon current industry standards. During CEA's inspection, all accessible areas were visually surveyed for the presence of suspect asbestos-containing materials. Inaccessible areas, such as behind solid ceilings or behind solid walls were not surveyed. Areas inspected for suspect asbestos-containing materials were limited to those designated by the scope of services. All samples were collected by individuals who have completed EPA approved asbestos inspector/management planner courses. Samples were collected and submitted for analysis via polarized light microscopy at CEA's NVLAP accredited laboratory.

CEA, by the virtue of providing the services described in this report, does not assume the responsibility of the person(s) in charge of the site, or otherwise undertake responsibility for reporting to any local, State, or Federal public agencies any conditions at the site that may present a potential danger to public health, safety, or the environment. It is the Client's responsibility to notify the appropriate local, state, or federal public agencies as required by law, or otherwise to disclose, in a timely manner, any information that may be necessary to prevent any danger to public health, safety, or the environment.

Under this scope of services, CEA assumes no responsibility regarding response actions (O&M plan, encapsulation, abatement, removal, etc.) initiated as a result of these findings. Response actions are the sole responsibility of the Client and should be conducted in accordance with local, State, and/or Federal requirements, and should be performed by appropriate licensed-asbestos personnel, as warranted.

ATTACHMENT A
TABLES

TABLE I
ASBESTOS SAMPLE RESULTS
Store 2250
Morganton, North Carolina

Sample	Sample Description	Sample Location	Condition	Friable	Asbestos (%)
2250-1	Hardboard Ceiling Tile	Deli / Entrance Bathrooms	N/A	N/A	None Detected
2250-2	Hardboard Ceiling Tile	“	N/A	N/A	None Detected
2250-3	Drywall	Interior Walls	N/A	N/A	None Detected
2250-4	Drywall	“	N/A	N/A	None Detected
2250-5	Drywall Joint Compound	“	N/A	N/A	None Detected
2250-6	Drywall Joint Compound	“	N/A	N/A	None Detected
2250-7	Drywall Joint Compound	“	N/A	N/A	None Detected
2250-8	Floor Tile (white)	Display Area / Office Break Room	N/A	N/A	None Detected
2250-8	Mastic (yellow)	“	N/A	N/A	None Detected
2250-9	Floor Tile (white)	“	N/A	N/A	None Detected
2250-9	Mastic (yellow)	“	N/A	N/A	None Detected
2250-10	Floor Tile (red)	Periodic Display Area	N/A	N/A	None Detected
2250-10	Mastic (yellow)	“	N/A	N/A	None Detected
2250-11	Floor Tile (red)	“	N/A	N/A	None Detected
2250-11	Mastic (yellow)	“	N/A	N/A	None Detected
2250-12	Floor Tile (orange)	“	N/A	N/A	None Detected
2250-12	Mastic (yellow)	“	N/A	N/A	None Detected
2250-12	Leveling Compound	“	N/A	N/A	None Detected
2250-13	Floor Tile (orange)	“	N/A	N/A	None Detected
2250-13	Mastic (yellow)	“	N/A	N/A	None Detected

2250-14	Vinyl Wallboard Adhesive	Produce / Meat / Deli Departments	N/A	N/A	None Detected
2250-15	Vinyl Wallboard Adhesive	“	N/A	N/A	None Detected
2250-16	Ceramic Tile Grout (gray)	Bathroom Floors	N/A	N/A	None Detected
2250-17	Ceramic Tile Grout (gray)	“	N/A	N/A	None Detected
2250-18	Ceramic Tile Grout (gray)	Bathroom Walls	N/A	N/A	None Detected
2250-19	Ceramic Tile Grout (gray)	“	N/A	N/A	None Detected
2250-20	Textured Floor Tile (white)	Produce Area	N/A	N/A	None Detected
2250-20	Mastic (gray)	“	N/A	N/A	None Detected
2250-21	Textured Floor Tile (white)	“	N/A	N/A	None Detected
2250-21	Mastic (gray)	“	N/A	N/A	None Detected
2250-22	Textured Floor Tile (black)	“	N/A	N/A	None Detected
2250-23	Textured Floor Tile (black)	“	N/A	N/A	None Detected
2250-24	Textured Floor Tile (blue)	“	N/A	N/A	None Detected
2250-25	Textured Floor Tile (blue)	“	N/A	N/A	None Detected
2250-26	Textured Concrete	Meat & Deli Departments	N/A	N/A	None Detected
2250-27	Textured Concrete	“	N/A	N/A	None Detected
2250-28	Textured Ceramic Tile Grout (gray)	Entrance Area Floors	N/A	N/A	None Detected
2250-29	Textured Ceramic Tile Grout (gray)	“	N/A	N/A	None Detected
2250-30	Vinyl Baseboard Adhesive	Periodic Walls	N/A	N/A	None Detected
2250-31	Vinyl Baseboard Adhesive	“	N/A	N/A	None Detected
2250-32	Caulking (black)	Windows & Exterior Door Frames	N/A	N/A	None Detected
2250-33	Caulking (black)	“	N/A	N/A	None Detected
2250-34	Stucco	Limited Facade	N/A	N/A	None Detected
2250-35	Stucco	“	N/A	N/A	None Detected

ATTACHMENT B
CERTIFICATE OF ANALYSIS

July 23, 2019

Commonwealth Environmental Associates, Inc.
7411 Iron Bridge Road
Richmond, VA 23237

CLIENT PROJECT: Store 2250 - Closed Bi-Lo - Morganton, NC, 22419
CEI LAB CODE: A1914282

Dear Customer:

Enclosed are asbestos analysis results for PLM Bulk samples received at our laboratory on July 16, 2019. The samples were analyzed for asbestos using polarizing light microscopy (PLM) per the EPA 600 Method.

Sample results containing >1% asbestos are considered asbestos-containing materials (ACMs) per EPA regulatory requirements. The detection limit for the EPA 600 Method is <1% asbestos by weight as determined by visual estimation.

Thank you for your business and we look forward to continuing good relations.

Kind Regards,



Tianbao Bai, Ph.D., CIH
Laboratory Director

ASBESTOS ANALYTICAL REPORT

By: Polarized Light Microscopy

Prepared for

Commonwealth Environmental Associates, Inc.

CLIENT PROJECT: Store 2250 - Closed Bi-Lo - Morganton, NC, 22419

LAB CODE: A1914282

TEST METHOD: EPA 600 / R93 / 116 and EPA 600 / M4-82 / 020

REPORT DATE: 07/23/19

TOTAL SAMPLES ANALYZED: 35

SAMPLES >1% ASBESTOS:



CEI

Asbestos Report Summary

By: POLARIZING LIGHT MICROSCOPY

PROJECT: Store 2250 - Closed Bi-Lo - Morganton,
NC, 22419

LAB CODE: A1914282

METHOD: EPA 600 / R93 / 116 and EPA 600 / M4-82 / 020

Client ID	Layer	Lab ID	Color	Sample Description	ASBESTOS %
2250-1		A194412	Gray	Sheetrock	None Detected
2250-2		A194413	Gray	Sheetrock	None Detected
2250-3		A194414	Gray	Sheetrock	None Detected
2250-4		A194415	Gray	Sheetrock	None Detected
2250-5		A194416	White	Mud Compound	None Detected
2250-6		A194417	White	Mud Compound	None Detected
2250-7		A194418	White	Mud Compound	None Detected
2250-8		A194419A	Cream	Tile	None Detected
		A194419B	Yellow	Adhesive	None Detected
2250-9		A194420A	Cream	Tile	None Detected
		A194420B	Yellow	Adhesive	None Detected
2250-10		A194421A	Red	Tile	None Detected
		A194421B	Yellow	Adhesive	None Detected
2250-11		A194422A	Red	Tile	None Detected
		A194422B	Yellow	Adhesive	None Detected
2250-12		A194423A	Orange	Tile	None Detected
	Layer 1	A194423B	Yellow	Adhesive	None Detected
	Layer 2	A194423B	Gray	Leveling Compound	None Detected
2250-13		A194424A	Orange	Tile	None Detected
		A194424B	Yellow	Adhesive	None Detected
2250-14		A194425	Brown	Adhesive	None Detected
2250-15		A194426	Brown	Adhesive	None Detected
2250-16		A194427	Gray	Cementitious Material	None Detected
2250-17		A194428	Gray	Cementitious Material	None Detected
2250-18		A194429	White	Mud	None Detected
2250-19		A194430	White	Mud	None Detected
2250-20		A194431A	Gray	Tile	None Detected
		A194431B	Yellow	Adhesive	None Detected
2250-21		A194432A	Gray	Tile	None Detected
		A194432B	Gray	Adhesive	None Detected
2250-22		A194433	Black	Tile	None Detected

PROJECT: Store 2250 - Closed Bi-Lo - Morganton,
NC, 22419

LAB CODE: A1914282

METHOD: EPA 600 / R93 / 116 and EPA 600 / M4-82 / 020

Client ID	Layer	Lab ID	Color	Sample Description	ASBESTOS %
2250-23		A194434	Black	Tile	None Detected
2250-24		A194435	Blue	Tile	None Detected
2250-25		A194436	Blue	Tile	None Detected
2250-26		A194437	Red,White	Epoxy	None Detected
2250-27		A194438	Red,White	Epoxy	None Detected
2250-28		A194439	Black	Cementitious Material	None Detected
2250-29		A194440	Black	Cementitious Material	None Detected
2550-30		A194441	White	Adhesive	None Detected
2550-31		A194442	White	Adhesive	None Detected
2250-32		A194443	Black	Putty	None Detected
2250-33		A194444	Black	Putty	None Detected
2250-34		A194445	White	Efis	None Detected
2250-35		A194446	White	Plaster	None Detected

ASBESTOS BULK ANALYSIS

By: POLARIZING LIGHT MICROSCOPY

Client: Commonwealth Environmental Associates, Inc.
7411 Iron Bridge Road
Richmond, VA 23237

Lab Code: A1914282
Date Received: 07-16-19
Date Analyzed: 07-17-19
Date Reported: 07-23-19

Project: Store 2250 - Closed Bi-Lo - Morganton, NC, 22419

ASBESTOS BULK PLM, EPA 600 METHOD

Client ID Lab ID	Lab Description	Lab Attributes	NON-ASBESTOS COMPONENTS				ASBESTOS
			Fibrous		Non-Fibrous		%
2250-1 A194412	Sheetrock	Heterogeneous Gray Fibrous Bound	15% 5%	Cellulose Fiberglass	80%	Gypsum	None Detected
2250-2 A194413	Sheetrock	Heterogeneous Gray Fibrous Bound	15% 5%	Cellulose Fiberglass	80%	Gypsum	None Detected
2250-3 A194414	Sheetrock	Heterogeneous Gray Fibrous Bound	15% 5%	Cellulose Fiberglass	75% 5%	Gypsum Paint	None Detected
2250-4 A194415	Sheetrock	Heterogeneous Gray Fibrous Bound	15% 5%	Cellulose Fiberglass	80%	Gypsum	None Detected
2250-5 A194416	Mud Compound	Heterogeneous White Non-fibrous Bound			60% 35% 5%	Calc Carb Silicates Paint	None Detected
2250-6 A194417	Mud Compound	Heterogeneous White Non-fibrous Bound			60% 35% 5%	Calc Carb Silicates Paint	None Detected
2250-7 A194418	Mud Compound	Heterogeneous White Non-fibrous Bound			60% 35% 5%	Calc Carb Silicates Paint	None Detected

ASBESTOS BULK ANALYSIS

By: POLARIZING LIGHT MICROSCOPY

Client: Commonwealth Environmental Associates, Inc.
7411 Iron Bridge Road
Richmond, VA 23237

Lab Code: A1914282
Date Received: 07-16-19
Date Analyzed: 07-17-19
Date Reported: 07-23-19

Project: Store 2250 - Closed Bi-Lo - Morganton, NC, 22419

ASBESTOS BULK PLM, EPA 600 METHOD

Client ID Lab ID	Lab Description	Lab Attributes	NON-ASBESTOS COMPONENTS		ASBESTOS %
			Fibrous	Non-Fibrous	
2250-8 A194419A	Tile	Homogeneous Cream Non-fibrous Bound		100% Vinyl	None Detected
A194419B	Adhesive	Homogeneous Yellow Non-fibrous Bound		100% Mastic	None Detected
2250-9 A194420A	Tile	Homogeneous Cream Non-fibrous Bound		100% Vinyl	None Detected
A194420B	Adhesive	Homogeneous Yellow Non-fibrous Bound		100% Mastic	None Detected
2250-10 A194421A	Tile	Homogeneous Red Non-fibrous Bound		100% Vinyl	None Detected
A194421B	Adhesive	Homogeneous Yellow Non-fibrous Bound		100% Mastic	None Detected
2250-11 A194422A	Tile	Homogeneous Red Non-fibrous Bound		100% Vinyl	None Detected

ASBESTOS BULK ANALYSIS

By: POLARIZING LIGHT MICROSCOPY

Client: Commonwealth Environmental Associates, Inc.
7411 Iron Bridge Road
Richmond, VA 23237

Lab Code: A1914282
Date Received: 07-16-19
Date Analyzed: 07-17-19
Date Reported: 07-23-19

Project: Store 2250 - Closed Bi-Lo - Morganton, NC, 22419

ASBESTOS BULK PLM, EPA 600 METHOD

Client ID Lab ID	Lab Description	Lab Attributes	NON-ASBESTOS COMPONENTS		ASBESTOS %
			Fibrous	Non-Fibrous	
A194422B	Adhesive	Homogeneous Yellow Non-fibrous Bound		100% Mastic	None Detected
2250-12 A194423A	Tile	Homogeneous Orange Non-fibrous Bound		100% Vinyl	None Detected
Layer 1 A194423B	Adhesive	Homogeneous Yellow Non-fibrous Bound		100% Mastic	None Detected
Layer 2 A194423B	Leveling Compound	Homogeneous Gray Non-fibrous Bound		100% Binder	None Detected
2250-13 A194424A	Tile	Homogeneous Orange Non-fibrous Bound		100% Vinyl	None Detected
A194424B	Adhesive	Homogeneous Yellow Non-fibrous Bound		100% Mastic	None Detected
2250-14 A194425	Adhesive	Heterogeneous Brown Fibrous Bound	10% Cellulose	90% Mastic	None Detected

ASBESTOS BULK ANALYSIS

By: POLARIZING LIGHT MICROSCOPY

Client: Commonwealth Environmental Associates, Inc.
7411 Iron Bridge Road
Richmond, VA 23237

Lab Code: A1914282
Date Received: 07-16-19
Date Analyzed: 07-17-19
Date Reported: 07-23-19

Project: Store 2250 - Closed Bi-Lo - Morganton, NC, 22419

ASBESTOS BULK PLM, EPA 600 METHOD

Client ID Lab ID	Lab Description	Lab Attributes	NON-ASBESTOS COMPONENTS				ASBESTOS %
			Fibrous		Non-Fibrous		
2250-15 A194426	Adhesive	Heterogeneous Brown Fibrous Bound	10%	Cellulose	90%	Mastic	None Detected
2250-16 A194427	Cementitious Material	Heterogeneous Gray Non-fibrous Bound			75% 25%	Silicates Binder	None Detected
2250-17 A194428	Cementitious Material	Heterogeneous Gray Non-fibrous Bound			75% 25%	Silicates Binder	None Detected
2250-18 A194429	Mud	Homogeneous White Non-fibrous Bound			75% 25%	Calc Carb Binder	None Detected
2250-19 A194430	Mud	Homogeneous White Non-fibrous Bound			75% 25%	Calc Carb Binder	None Detected
2250-20 A194431A	Tile	Homogeneous Gray Non-fibrous Bound			100%	Vinyl	None Detected
A194431B	Adhesive	Homogeneous Yellow Non-fibrous Bound			100%	Mastic	None Detected

ASBESTOS BULK ANALYSIS

By: POLARIZING LIGHT MICROSCOPY

Client: Commonwealth Environmental Associates, Inc.
7411 Iron Bridge Road
Richmond, VA 23237

Lab Code: A1914282
Date Received: 07-16-19
Date Analyzed: 07-17-19
Date Reported: 07-23-19

Project: Store 2250 - Closed Bi-Lo - Morganton, NC, 22419

ASBESTOS BULK PLM, EPA 600 METHOD

Client ID Lab ID	Lab Description	Lab Attributes	NON-ASBESTOS COMPONENTS		ASBESTOS %
			Fibrous	Non-Fibrous	
2250-21 A194432A	Tile	Homogeneous Gray Non-fibrous Bound		100% Vinyl	None Detected
A194432B	Adhesive	Homogeneous Gray Non-fibrous Bound		100% Mastic	None Detected
2250-22 A194433	Tile	Homogeneous Black Non-fibrous Bound		100% Vinyl	None Detected
2250-23 A194434	Tile	Homogeneous Black Non-fibrous Bound		100% Vinyl	None Detected
2250-24 A194435	Tile	Homogeneous Blue Non-fibrous Bound		100% Vinyl	None Detected
2250-25 A194436	Tile	Homogeneous Blue Non-fibrous Bound		100% Vinyl	None Detected
2250-26 A194437	Epoxy	Heterogeneous Red, White Non-fibrous Bound	75% 25%	Binder Mastic	None Detected

ASBESTOS BULK ANALYSIS

By: POLARIZING LIGHT MICROSCOPY

Client: Commonwealth Environmental Associates, Inc.
7411 Iron Bridge Road
Richmond, VA 23237

Lab Code: A1914282
Date Received: 07-16-19
Date Analyzed: 07-17-19
Date Reported: 07-23-19

Project: Store 2250 - Closed Bi-Lo - Morganton, NC, 22419

ASBESTOS BULK PLM, EPA 600 METHOD

Client ID Lab ID	Lab Description	Lab Attributes	NON-ASBESTOS COMPONENTS				ASBESTOS %
			Fibrous		Non-Fibrous		
2250-27 A194438	Epoxy	Heterogeneous Red,White Non-fibrous Bound			75% 25%	Binder Mastic	None Detected
2250-28 A194439	Cementitious Material	Homogeneous Black Non-fibrous Bound			75% 25%	Silicates Binder	None Detected
2250-29 A194440	Cementitious Material	Homogeneous Black Non-fibrous Bound			75% 25%	Silicates Binder	None Detected
2550-30 A194441	Adhesive	Heterogeneous White Non-fibrous Bound	10%	Cellulose	90%	Mastic	None Detected
2550-31 A194442	Adhesive	Heterogeneous White Non-fibrous Bound	10%	Cellulose	85% 5%	Mastic Paint	None Detected
2250-32 A194443	Putty	Homogeneous Black Non-fibrous Bound			100%	Caulk	None Detected
2250-33 A194444	Putty	Homogeneous Black Non-fibrous Bound			100%	Caulk	None Detected

ASBESTOS BULK ANALYSIS

By: POLARIZING LIGHT MICROSCOPY

Client: Commonwealth Environmental Associates, Inc.
7411 Iron Bridge Road
Richmond, VA 23237

Lab Code: A1914282

Date Received: 07-16-19

Date Analyzed: 07-17-19

Date Reported: 07-23-19

Project: Store 2250 - Closed Bi-Lo - Morganton, NC, 22419

ASBESTOS BULK PLM, EPA 600 METHOD

Client ID Lab ID	Lab Description	Lab Attributes	NON-ASBESTOS COMPONENTS				ASBESTOS %
			Fibrous		Non-Fibrous		
2250-34 A194445	Efis	Heterogeneous	10%	Cellulose	30%	Foam	None Detected
		White			40%	Silicates	
		Fibrous			20%	Calc Carb	
		Bound					
2250-35 A194446	Plaster	Heterogeneous			75%	Silicates	None Detected
		White			25%	Binder	
		Non-fibrous					
		Bound					

LEGEND:

Non-Anth	= Non-Asbestiform Anthophyllite
Non-Trem	= Non-Asbestiform Tremolite
Calc Carb	= Calcium Carbonate

METHOD: EPA 600 / R93 / 116 and EPA 600 / M4-82 / 020

REPORTING LIMIT: <1% by visual estimation

REPORTING LIMIT FOR POINT COUNTS: 0.25% by 400 Points or 0.1% by 1,000 Points

REGULATORY LIMIT: >1% by weight

Due to the limitations of the EPA 600 method, nonfriable organically bound materials (NOBs) such as vinyl floor tiles can be difficult to analyze via polarized light microscopy (PLM). EPA recommends that all NOBs analyzed by PLM, and found not to contain asbestos, be further analyzed by Transmission Electron Microscopy (TEM). Please note that PLM analysis of dust and soil samples for asbestos is not covered under NVLAP accreditation. *Estimated measurement of uncertainty is available on request.*

This report relates only to the samples tested or analyzed and may not be reproduced, except in full, without written approval by Eurofins CEI. Eurofins CEI makes no warranty representation regarding the accuracy of client submitted information in preparing and presenting analytical results. Interpretation of the analytical results is the sole responsibility of the client. Samples were received in acceptable condition unless otherwise noted. This report may not be used by the client to claim product endorsement by NVLAP or any other agency of the U.S. Government.

Information provided by customer includes customer sample ID, location, volume and area as well as date and time of sampling.

ANALYST:

 Ryan Steele

APPROVED BY:

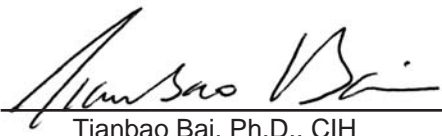
 Tianbao Bai, Ph.D., CIH
 Laboratory Director

 Megan Fisher

A1914282

EUROFINS CEI, INC.
SAMPLES ACCEPTED

35



A194412-A194446

FG

Commonwealth Environmental Associates, Inc.

7411 Iron Bridge Rd. • Richmond, VA 23237 • 804.275.9320 • Fax: 804.275.9322

1 of 2

ASBESTOS SAMPLING CHAIN OF CUSTODY RECORD

Project #: 22419 Project Name: Store 2250 - Closed Bi-Lo - Morganton, NC
 Samplers: Project MGR:
 Lab Name: Lab Contact:
 Lab Address:

				ANALYSIS	
Sample ID	Date	Sample Location	# of Containers	Bulk PLM	Other
2250-1	7/10/19	Store 2250	1		
-2					
-3					
-4					
-5					
-6					
-7					
-8					
-9					
-10					
-11					
-12					
-13					
-14					
-15					
-16					
-17					
-18					
-19					
-20					
-21					
-22					
-23					
-24					
-25					
-26					
-27					
-28					
2250-29					
-30					

(Signature) / (Signature) /
 (Signature) / (Signature) /
 (Signature) / (Signature) /

Turn Around Time: ☐ Regular ☐ Priority ☐ Other

Notes:

eurofins

Received By:

FG 7/16/19

9:50

A1914282

CEA 22419



Commonwealth Environmental Associates, Inc.

7411 Iron Bridge Rd. • Richmond, VA 23237 • 804.275.9320 • Fax: 804.275.9322

2012

22419 ASBESTOS SAMPLING CHAIN OF CUSTODY RECORD

Project #: 22419 Project Name: Store 2250 - Closed Bi-Lo - Morganton NC

Samplers: Project MGR:

Lab Name: Lab Contact:

Lab Address:

				ANALYSIS	
Sample ID	Date	Sample Location	# of Containers	Bulk PLM	Other
2250 -31	2/10/12	Store 2250	1	X	
-32					
-33					
-34					
-35					
-36					
-37					
-38					
-39					
-40					
-41					
-42					
-43					
-44					
-45					
-46					
-47					
-48					
-49					
-50					
-51					
-52					
-53					
-54					
-55					
-56					
-57					
-58					
-59					
-60					

(Signature) / (Signature) /
 (Signature) / (Signature) /
 (Signature) / (Signature) /

Turn Around Time: ☐ Regular ☐ Priority ☐ Other _____

Notes:

ATTACHMENT C

MAP

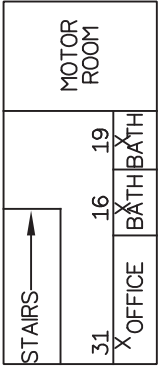

2nd FLOOR

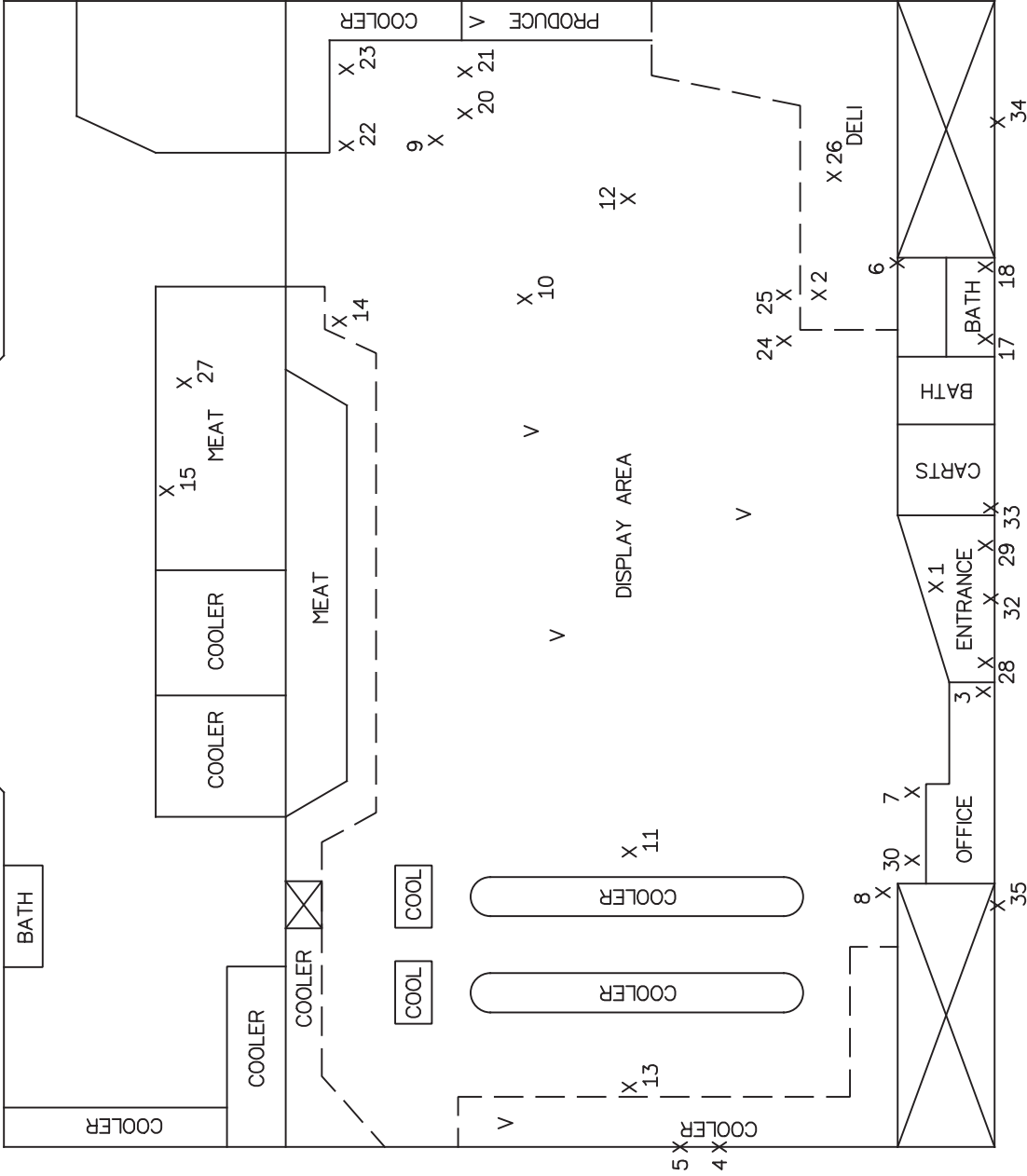

1555 E. UNION STREET
MORGANTON, NC

STORE 2250

PROJECT # : 22419	DATE: 07/24/2019	DESIGN BY: WFM	CLIENT: FOOD LION
APPROVED BY: WFM	DWG # : 22419-1	DRAWN BY: AEF	SCALE: NOT TO SCALE

COMMONWEALTH ENVIRONMENTAL ASSOCIATES, INC.

7411 IRON BRIDGE ROAD, RICHMOND, VIRGINIA 23237